

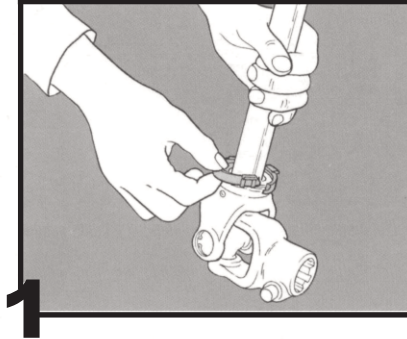

# Weasler® EASY LOCK GUARD

## SERVICE INSTRUCTIONS



1 Clean and grease bushing groove before the bushing is placed in the groove. Grease any remaining bushings in guard.

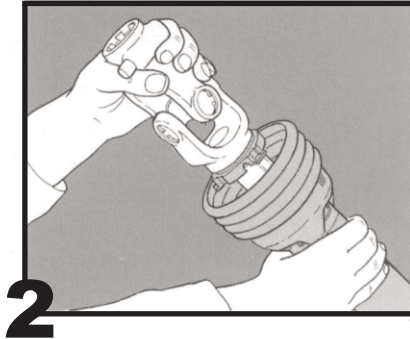

2 Slide guard half over drive shaft and insert bushing tabs into the openings in the guard.

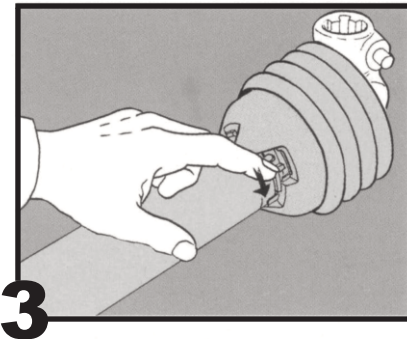

3 Turn the bushing until it engages into the guard.

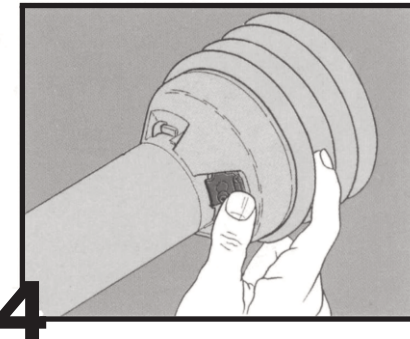

4 Push *Easy Lock* clip into position. The bushing and guard are now secure.

5 **TO REMOVE GUARD** - Use screwdriver to release *Easy Lock* clip. Turn the bushing to disengage from the guard and remove guard.

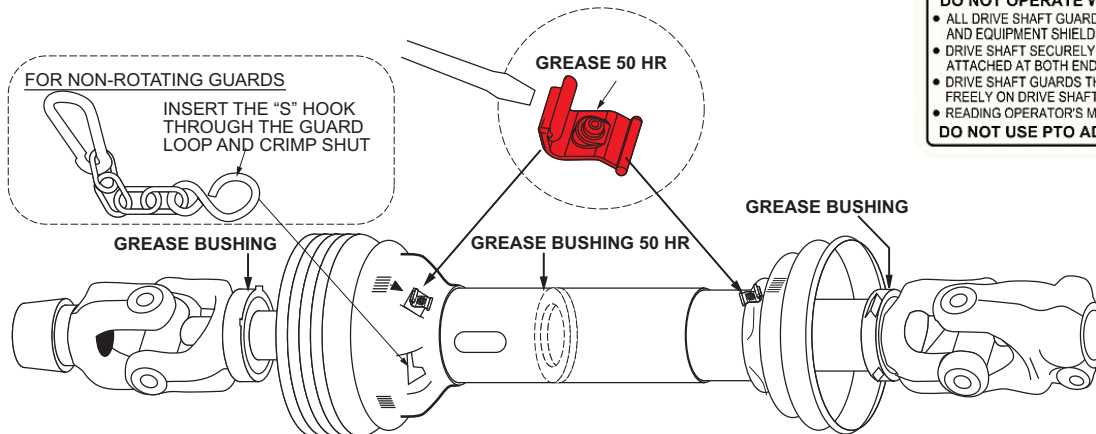

### TOOLS REQUIRED

- (1) Screwdriver
- (2) High Quality Multi-Purpose Grease
- (3) Pliers

### IMPORTANT

**CHECK THAT GUARD MISSING DECAL ON STEEL TUBE UNDER INNER GUARD AND ROTATING DRIVE SHAFT DECAL ON OUTER GUARD ARE FIRMLY AFFIXED, UNDAMAGED AND READABLE - IF NOT, REPLACE.**



UNCONTROLLED DOCUMENT 56-15135-02

Weasler Engineering, Inc.  
P.O. Box 558, West Bend, WI 53095 USA  
Tel: +1-262.338.2161, Fax: +1-262.338.3709  
E-mail: oemsales@weasler.com  
web site: www.weasler.com

Weasler Engineering BV  
P.O. Box 266, 6600 AG, Wijchen, The Netherlands  
Tel: +31 (0)24 64 89 100, Fax: +31 (0)24 64 89 109  
E-mail: sales@weasler.nl  
web site: www.weasler.com

Weasler Engineering Kft  
P.O. Box 262, H6001, Kecskemet, Hungary  
Tel: +36 (0)76 500 410, Fax: +36 (0)76 500 415  
E-mail: sales@weasler.nl  
web site: www.weasler.com