

CTD 10 BOLT HUBS W/ BEARING CUPS

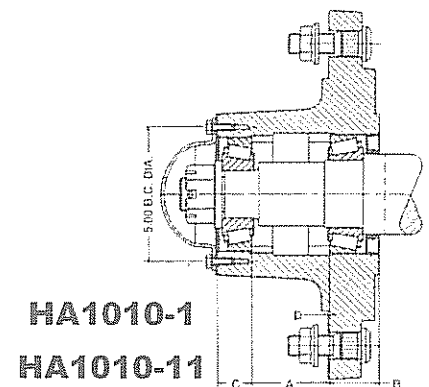
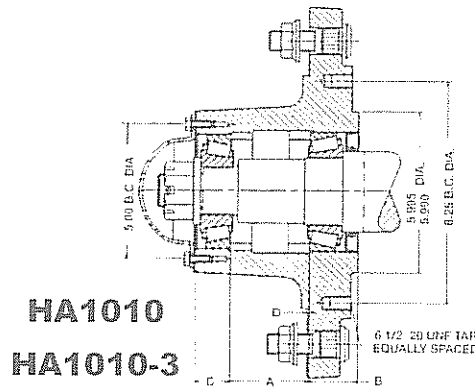

HUB NO.	INNER CUP	OUTER CUP	INNER CONE	INNER BORE	OUTER CONE	OUTER BORE	DUST CAP NO.	WHEEL BOLT NO.	GREASE SEAL NO.	A	B	C	D	SPINDLE NO.	CAP. LBS.
HUB HA1010	39520	453A	39585	2.50	460	1.75	DC27	WB51 WB52	SE48	2.81	1.75	1.25	0.06	HUB S1010	12,000
HUB HA1010-1	39520	453A	39585	2.50	460	1.75	DC27	WB51 WB52	SE48	2.81	1.75	1.25	0.06	HUB S1010	12,000
HUB HA1010-3	33462	453A	33275	2.75	460	1.75	DC27	WB51 WB52	SE67	2.81	1.75	1.25	0.06	HUB S1010-3	15,000
HUB HA1010-11	33462	453A	33275	2.75	460	1.75	DC27	WB51 WB52	SE67	2.81	1.75	1.25	0.06	HUB S1010-3	15,000

GREASE SEALS

403-20
A13 265

SEAL NO.	TYPE	A (ID)	B (OD)	C (WIDTH)	SEAL NO.	TYPE	A (ID)	B (OD)	C (WIDTH)
SE10	A	1.21	1.983	0.406	SE26	A	2.25	3.376	0.438
SE11	A	1.50	2.332	0.500	SE27	A	2.00	2.969	0.312
SE12	A	1.62	2.332	0.438	SE28	A	1.50	2.627	0.250
SE13	A	1.75	2.722	0.359	SE29	A	2.00	3.153	0.250
SE13X	A	1.75	2.754	0.350	SE30	A	2.00	3.548	0.469
SE14	A	1.62	2.566	0.250	SE33	B	1.50	2.566	0.290
SE15	A	1.37	2.332	0.410	SE35	A	1.87	2.754	0.500
SE16	A	2.00	3.630	0.250	SE38	A	2.00	3.628	0.500
SE17	A	2.50	3.881	0.469	SE39	B	1.62	2.566	0.290
SE18	A	2.13	3.381	0.375	SE40	A	2.09	2.754	0.250
SE19	A	1.00	1.785	0.469	SE41	SE A/B	2.00	3.628	0.250
SE22	A	1.68	2.566	0.500	SE42	A	3.00	4.008	0.438
SE23	A	2.29	3.153	0.359	SE44	A	2.00	3.066	0.250
SE24	A	2.00	2.722	0.250	SE63	A	2.25	3.066	0.250

265044
TYPE A

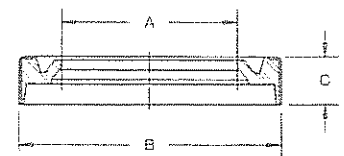

TYPE B

