

Bale Spears

Receiver Style Bale Spear Model #33016

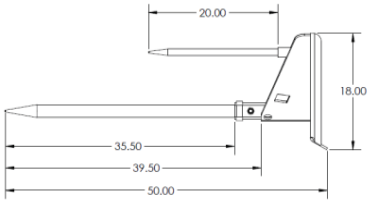

- Replaceable main spear & stabilizing spears

Specifications	
Width	46"
Height	18"
Overall Depth	50"
Main Spear	43" Spear Bolt in Spear, 35½" Useable Length (P#33016-03)
Stabilizer Spear	23" Spear, 20" useable length (P#33016-02)
Max Lift	Total Max Load 1500 lbs
Weight	155 lbs

Single Bale Spear (Econo) Model #33189

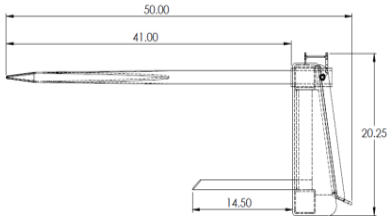
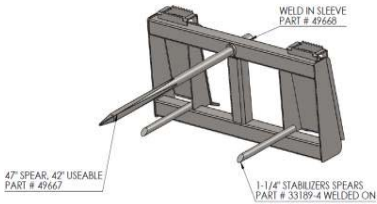

- Economical way to move a single bale

Specifications	
Width	46"
Height	20"
Overall Depth	50"
Spear	47" Spear Bolt in Spear, 42" Useable Length
Sleeve	Weld in Sleeve (P# 49668)
Max Lift	Total Max Load 3000 lbs
Weight	189 lbs

Single Bale Spear Model #33124

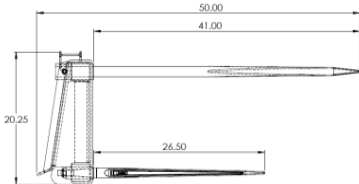
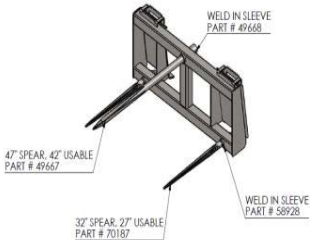

- Single Bale Moving • Durable Construction

Specifications	
Width	46"
Height	20"
Overall Depth	50"
Main Spear	47" Spear Bolt in Spear, 42" Useable Length (P#49667)
Main Sleeve	Weld in Sleeve (P# 49668)
Stabilizer Spear	32" Spear, 27 useable length (P#70187)
Stabilizer Sleeve	Weld on sleeve (P#58928)
Max Lift	Total Max Load 3000 lbs
Weight	189 lbs

Bale Spears

Double Bale Spear Model #33160

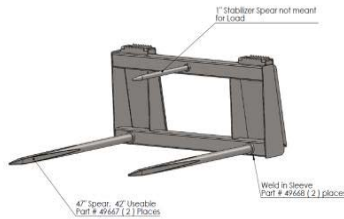

- Bottom lift ability allows for higher lifting

Specifications	
Width	46"
Height	20"
Overall Depth	50"
Width Between Spears	36"
Spear	47" Spear Bolt in Spear, 42" Useable Length (P# 49667)
Sleeve	Weld in Sleeve (P# 49668)
Stabilizer Spear	1" Cold Roll Round 23" Spear, 18½" Useable (P# 33160-7)
Max Lift	Total Max Load 3000 lbs
Weight	190 lbs

Triple Bale Spear Model #33159

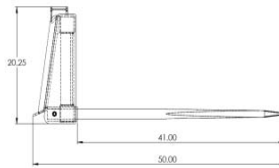
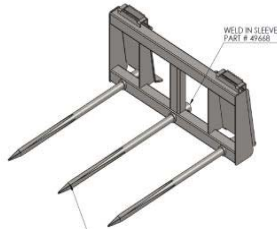

- Best suited for large round or square bales

Specifications	
Width	46"
Height	20"
Overall Depth	50"
Width Between Spears	36"
Spear	47" Spear Bolt in Spear, 42" Useable Length (P# 49667)
Sleeve	Weld in Sleeve (P# 49668)
Max Lift	Total Max Load 3000 lbs
Weight	224 lbs

Double Round Bale Spear Model #33125

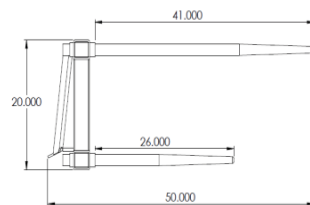

- Double Bale moving saves time

Specifications	
Width	68"
Height	20"
Overall Depth	50"
Width Between Top Spears	60"
Width Between Bottom Spears	42"
Tapered Spears with nut	49" Spear Bolt in Spear, 44" Useable Length (P# 44119) 3500 LB max
Sleeve	Weld in Sleeve (P# 44132)
Tapered Stabilizer Spears with nuts	32" Spear Bolt in Spear, 27" Useable Length (P# 61413) 3500 LB max
Max Lift	Total Max Load 3000 lbs
Weight	325 lbs



BALE HANDLING		RETAIL	WEIGHT
33016	Bale Spear / Receiver Hitch	\$720.00	155
33124	Bale Spear, Single Bale - 3500 lb. capacity	\$991.00	200
33125	Bale Spear, Double Bale - 3500 lb. capacity	\$1577.00	325
33189	Single Bale Spear - Round - Econo	\$817.00	170
33160	Double Bale Spear - Round	\$876.00	190
33159	Triple Spear Bale Spear - Square	\$1064.00	215
33277	Square / Round Bale Spear Combo	\$1171.00	220
33302	Bale Spear/Pallet Fork Combo	\$2496.00	619
33302F	48.5" HD Walk-Thru Frame Only	\$1280.00	345
33016-02	1" x 23" Long Bale Spear (2 per unit)	\$39.00	5
33016-03	2" x 43" Long Bale Spear (1 per unit)	\$209.00	36
80489	Fork Tine - 48" 4400 lb. Lift Capacity (2 needed)	\$376.00	137
21615181	49" Spear (3 needed)	\$135.00	25
70187	32" Spear - 27" Usable (w/nut)	\$79.00	17
49667	47" Spear - 42" Usable (w/nut)	\$151.00	25
33160-7	23" Cold Roll Round Spear	\$39.00	5
33029-5	2" OD x 39-1/2" Long	\$184.00	34