

"BF" BALL BEARING

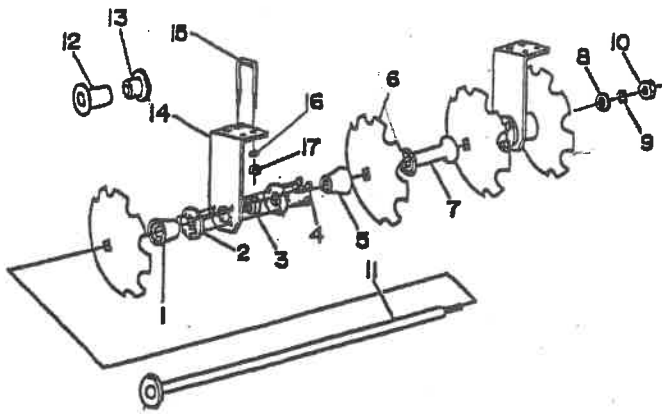

Ref. No.	Part No.	Description
1	10936	Convex End Spacer, 15/16" x 3"
2	10938	Flangette
3	10939	Bearing (205PPB 7C2)
4	10945	Hex Bolt, 5/16" x 3/4", Gr. 2
5	10937	Concave End Spacer, 15/16" x 3"
6		Disc Blade (See chart on page 65)
7	10940	Spacer Spool, 15/16" x 7 1/2"
8	10978	End Washer, 15/16"
9	T-21	Lockwasher, 7/8"
10	T-19	Hex Nut, 7/8" or
	T-19A	Lock Nut, 7/8"
11	10941	Round Axle, 15/16" x 17 1/8", 3 Bld.
	10942	Round Axle, 15/16" x 24 3/4", 4 Bld.
	10943	Round Axle, 15/16" x 32 3/8", 5 Bld.
12	10935	Special Half Spacer, 15/16" x 4 7/8"
13	10934	Special Half Spacer, 15/16" x 1 1/2"
14	11007	Gang Hanger
15	11138	U-Bolt, 2 x 2
16	T-25	Lockwasher, 1/2"
17	T-26	Hex Nut, 1/2"

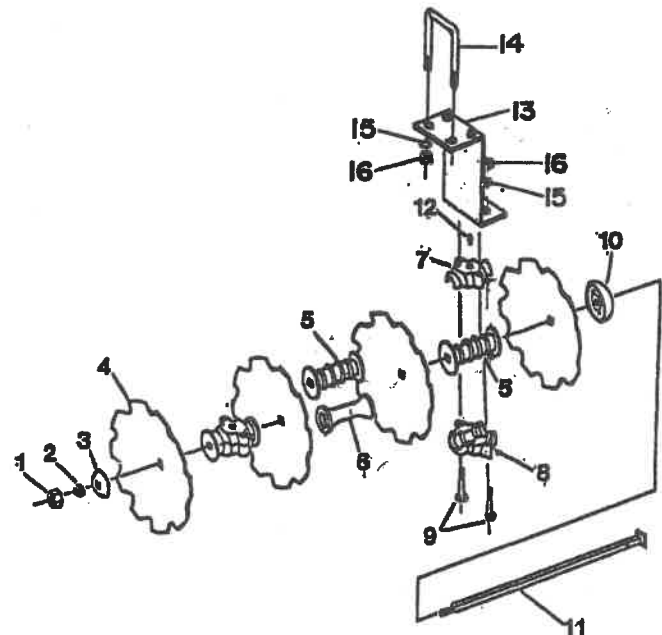

"F" FRICTION BEARING

Ref. No.	Part No.	Description
1	T-19	Hex Nut, 7/8"
2	T-21	Lockwasher, 7/8"
3	T-7	End Washer, 7/8" Sq.
4		Disc Blade (See chart on page 65)
5	T-10	Bearing Spool, 7/8" Sq. x 7 1/2"
6	T-8035	Fab Spacer Spool, 7/8" x 7 1/2"
7	T-12	Top Cap, 7 1/2" Spool
8	T-11	Bottom Cap, 7 1/2" Spool
9	T-734	Hex Bolt, 1/2" x 4", Gr. 2
10	T-8	Bumper Washer, 7/8" Sq.
11		Axle, 7/8" Sq. (See chart on page 67)
12	T-9	Grease Fitting
13	9650	Gang Hanger
14	11138	U-Bolt, 2 x 2
15	T-25	Lockwasher, 1/2"
16	T-26	Hex Nut, 1/2"

~~*~~ ECR 20

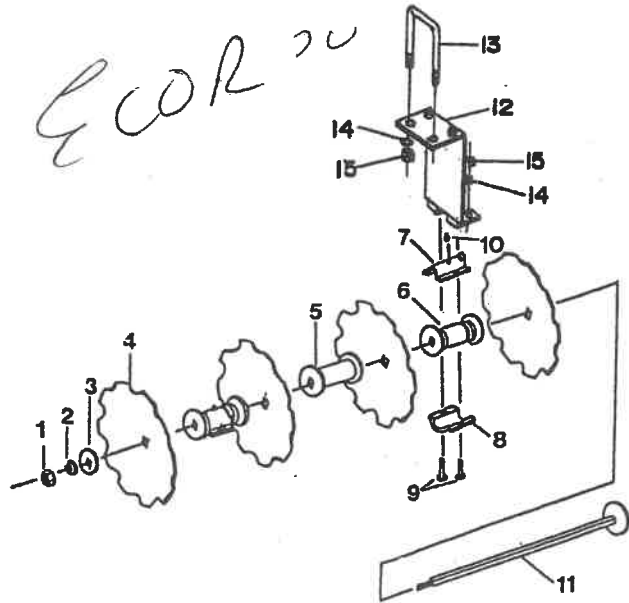

"ECO" ECONOMY BEARING

Ref. No.	Part No.	Description
1	T-19	Hex Nut, 7/8"
2	T-21	Lockwasher, 7/8"
3	T-8026	ECO End Washer, 7/8" Sq.
4		Disc Blade (See chart on page 65)
5	T-8035	ECO Spacer Spool, 7/8" Sq. x 7 1/2"
6	9684	ECO Bearing Spool, 7/8" Sq. x 7 1/2"
7	9679	Formed Top Cap, 7 1/2" ECO Spool
8	9683	Formed Bottom Cap, 7 1/2" ECO Spool
9	9678	Hex Bolt, 1/2" x 2", Gr. 2
10	T-9	Grease Fitting
11	11316	Axle, 7/8" x 17 3/8", 3 Blade
	11317	Axle, 7/8" x 25", 4 Blade
	11318	Axle, 7/8" x 32 5/8", 5 Blade
12	9685	Gang Hanger
13	11138	U-Bolt, 2 x 2
14	T-25	Lockwasher, 1/2"
15	T-26	Hex Nut, 1/2"