

ITEM	PART #	DOCUMENT #	DESCRIPTION	QTY.
1	BFR36	12X-SH-16	RAKE WHEEL SPINDLE (SHORT) REPLACES BFR30S	1
2	T1172	T1172	NUT, HEX, 18MM - 1.5, CASTLE, G2, NF	1
3	T163	T163	SEAL, 2.05 X 1.25 X .25	1
4	T173	T173	CAP. HUB, RAKE WHEEL	1
5	1088	1088	CLIP, RETAINING	1
6	600012	600012	BRG, 2.05 X 0.75, TAPER, COMPLETE	1
7	600014	600014	BRG, 1.85 X 0.75, TAPER, COMPLETE	1

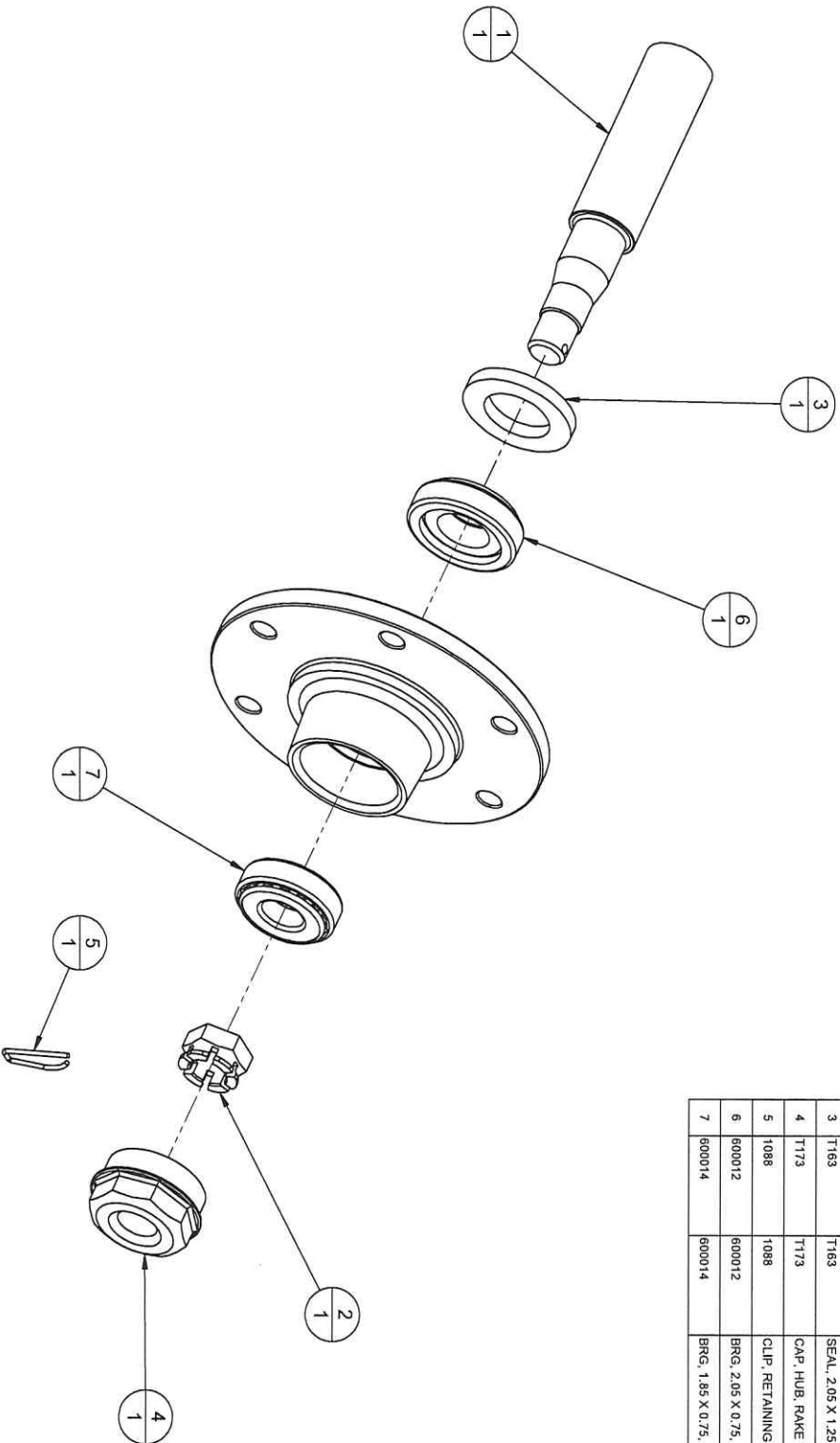

REV.	ECN	DESCRIPTION	DATE	BY
2	12457	REMOVED ITALIAN HUB FROM BOM (NON-SERVICIBLE)	4/29/2015	SRH
1	08972	SPINDLE MATCHES PRINT 12X-SH-25	12/14/11	GLW

<b>PROPRIETARY AND CONFIDENTIAL:</b>		TOLERANCE (UNLESS OTHERWISE SPECIFIED):		THIRD ANGLE PROJECTION	
THE INFORMATION CONTAINED IN THIS DRAWING IS THE SOLE PROPERTY OF H&S MFG. CO. ANY REPRODUCTION IN PART OR IN WHOLE, WITHOUT PERMISSION IS PROHIBITED.		+/- .015" +/- .1 DEG +/- .1 DEG √ = 12°		SHEET 1 OF 1	
DRAWING NAME: RAKE WHEEL HUB AND SPINDLE		REVISION: 0		PART NUMBER: 1081	
MATERIAL TYPE: -		DRAWN BY: mbenishkek		DATE: 12/6/2013	
PRODUCT CODE: AR1061		WEIGHT: 5.82		DRAWING #: 10ER-AS-25	

8 7 6 5 4 3 2 1