

- NOTES : 1.) FINISH - PAINT BLACK  
 2.) PART TO BE SHOT PEENED TO ALMEN C-7 MINIMUM, IN INDICATED AREA  
 3.) MAT'L - 1X2-1/2 5160 FLAT  
 4.) HARDNESS - ROCKWELL C 42-46

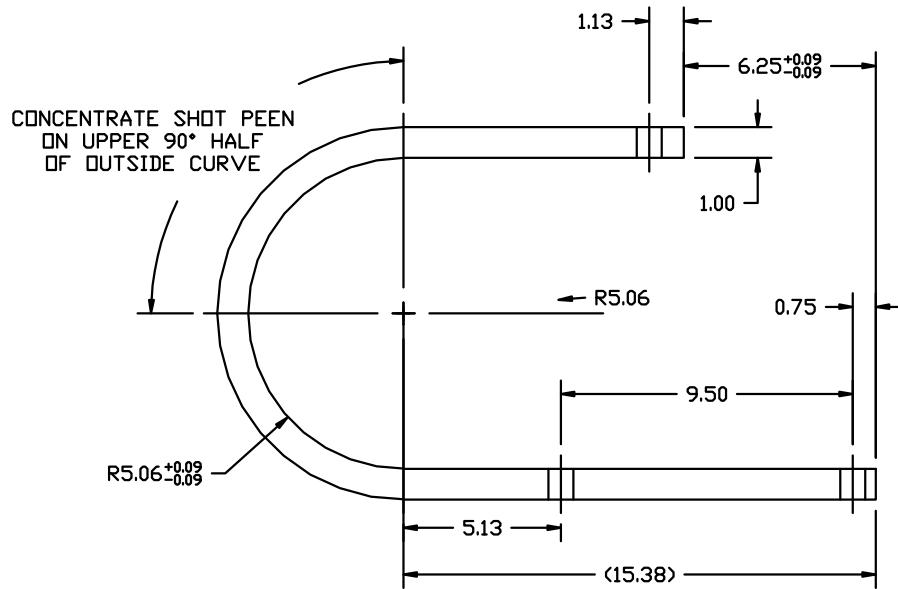
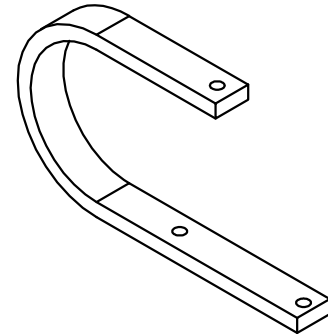
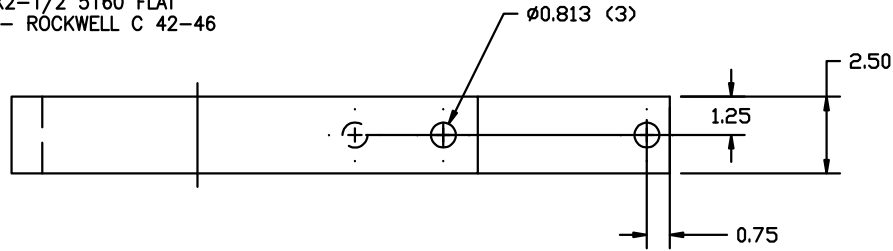

29.4 ( ) STD MIL TOL UNLESS SPEC.

				DWG NO.	MATERIAL		PPP		( ) STD MIL TOL UNLESS SPEC.			
				24520	TOLERANCE UNLESS SPECIFIED		WIL-RICH LLC					
					DECIMAL: .X ±.06 [1,5] .XX ±.03 [0,8] .XXX ±.015 [0,38]							
				RELEASE TO MDT		DO NOT SCALE THIS DRAWING		SPRING SHANK				
				REMOVE ALL SHARP EDGES		REMOVE ALL SHARP EDGES						
EO	BY	DATE	LTR	REVISION	ITEM	CLS	PREP	CHK	APVD	SCALE	DWG NO.	
							ALR	5-17-10	ALR	ALR	NONE	24520

TSC — NOTICE: WIL-RICH LLC claims proprietary rights to the information disclosed on this drawing. It is issued in confidence for engineering information only, and may not be reproduced or used to manufacture anything shown hereon without direct written permission from WIL-RICH LLC to the user.